

MA40T & MA50T EXPLODED VIEW

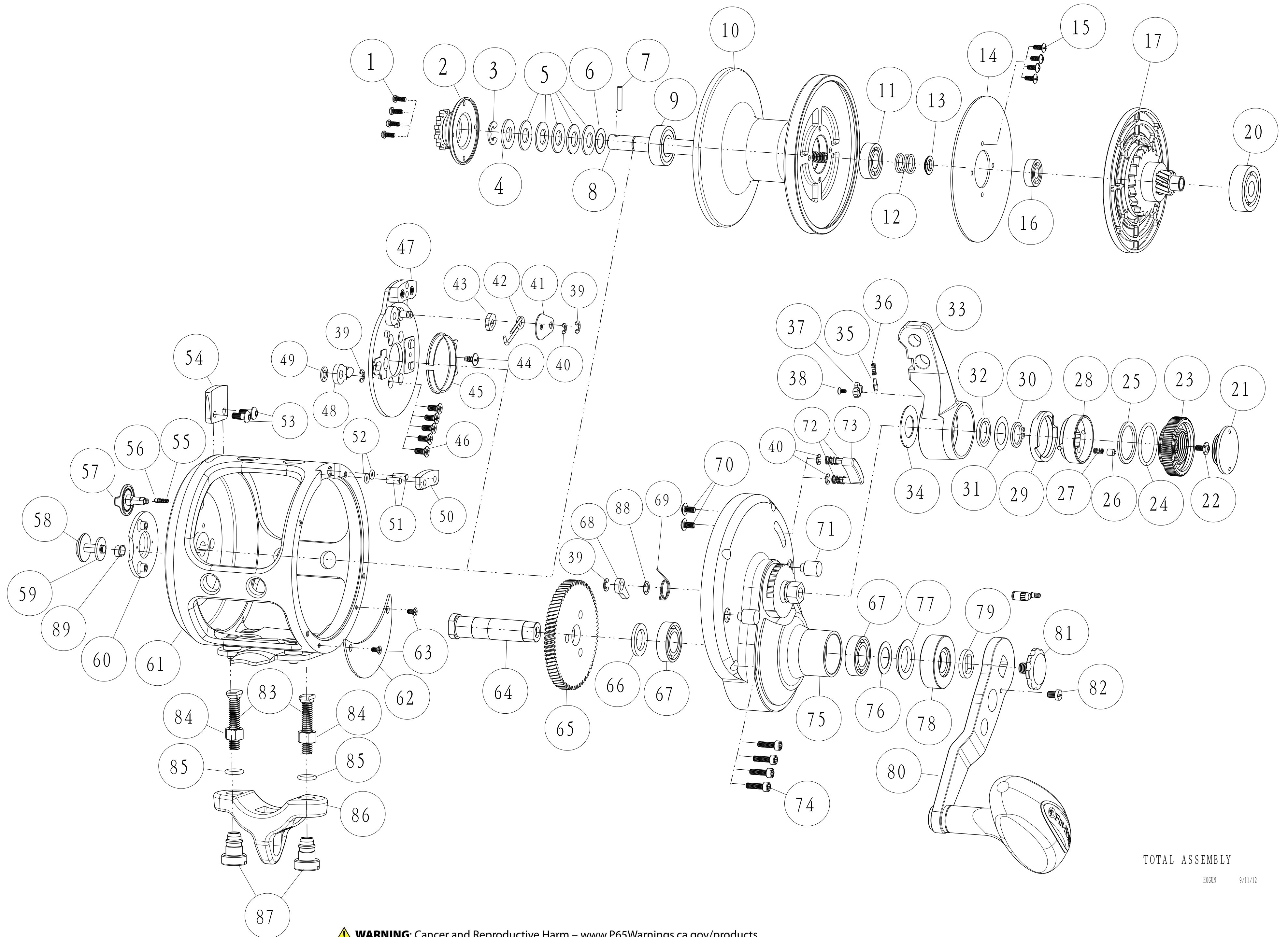

TOTAL ASSEMBLY

HOGON 9/11/12

⚠ WARNING: Cancer and Reproductive Harm – www.P65Warnings.ca.gov/products

FinNor Marquesa Lever Drag -MA40T,MA50T									
Key No.	Description	Part No.			Key No.	Description	Part No.		Q'TY
		MA40T	MA50T	Q'TY			MA40T	MA50T	
1	Screw	LF057-01	↔	4	46	Screw	TW107-04	↔	5
2	Bait Click Ratchet Assembly	GM329-01	↔	1	47	Click Plate Holder	CM129-01	↔	1
3	E-Ring	DF092-01	↔	1	48	Bait Click Pawl	DF109-02	↔	1
4	Collar	DF081-02	↔	1	49	Bait Click Lever Washer -B	CF035-01	↔	1
5	Drag Spring	JF046-01	↔	5	50	Harness Lug Spacer - Right	CM160-01	↔	1
6	Washer	CF121-01	↔	1	51	Pin	CM093-01	↔	2
7	Spool Shaft Pin	DF093-01	↔	1	52	O-Ring	CM101-01	↔	2
8	Spool Shaft	CM015-01	DM015-01	1	53	Screw	CM123-01	↔	2
9	Ball Bearing	VF017-02	↔	1	54	Harness Lug Spacer - Left	DM160-01	↔	1
10	Spool	CM021-01	DM021-01	1	55	Coil Spring	DF070-01	↔	1
11	Ball Bearing	KF017-01	↔	1	56	Teston Konb Click Pin	CF108-01	↔	1
12	Spring	CF040-01	↔	1	57	Tension Knob	CF026-01	↔	1
13	Collar	BF094-01	↔	1	58	Bait Click Lever	CF109-01	↔	1
14	Drag Disc	CM059-01	↔	1	59	Bait Click Lever Washer -A	CF032-01	↔	1
15	Screw	CM057-01	↔	1	60	Badge	CF148-01	↔	1
16	Ball Bearing	CF117-02	↔	1	61	Frame Assembly	CM301-02	DM301-02	1
17	Drag Plate Assembly	CM348-01	↔	1	62	Drive Gear Cover	CM143-01	↔	1
20	Ball Bearing	JF017-01	↔	1	63	Screw	CF107-01	↔	2
21	Pre Set Knob Cover	CF110-01	↔	1	64	Crank Shaft	GM008-01	↔	1
22	Screw	CX076-04	↔	1	65	Drive Gear	GM012-01	↔	1
23	Pre Set Knob	CF029-03	↔	1	66	Washer	GM035-01	↔	1
24	O-Ring	CF101-01	↔	1	67	Ball Bering	CF017-02	↔	2
25	Friction Washer	DF121-01	↔	1	68	Anti Reverse Pawl	DF063-02	↔	1
26	Click Pin	CF098-01	↔	1	69	Stopper Spring	CF096-01	↔	1
27	Click Spring	DF114-01	↔	1	70	Screw	QW123-10	↔	2
28	Drag Cam B Assembly	CF353-01	↔	1	71	Locating Collar	DF118-01	↔	2
29	Drag Cam A	CF028-01	↔	1	72	Strike Button Pin Spring	CF022-01	↔	2
30	External Ring	JF075-01	↔	1	73	Strike Button	CF062-02	↔	1
31	Adjustment Washer	CF038-02	↔	1	74	Screw	CF053-01	↔	4
32	Bushing	DF017-01	↔	1	75	Gear Side Cover Assembly	CM324-02	↔	1
33	Drag Lever	CM055-01	↔	1	76	Adjustment Washer	DF035-01	↔	1
34	Drag Lever Washer	BM038-01	↔	1	77	Rubber Seal	CM172-01	↔	1
35	Click Pawl	CM098-01	↔	1	78	Handle Washer	CM054-01	↔	1
36	Click Spring	CM114-01	↔	1	79	Spacer	AM160-01	↔	1
37	Screw	DW107-02	↔	1	80	Handle Arm Assembly	GM318-01	↔	1
38	Cover	CM161-01	↔	1	81	Handle Nut	CF003-01	↔	1
39	E-Clip	NX092-01	↔	4	82	Handle Nut Screw	CF065-01	↔	1
40	E-Clip	NX090-01	↔	3	83	Rod Clamping Bolt	CF125-01	↔	2
41	Holder	CF159-01	↔	1	84	Nut	JF003-01	↔	2
42	Torsion Spring	CF070-01	↔	1	85	O-Ring	LF101-01	↔	2
43	Cam	DF028-01	↔	1	86	Rod Clamp	XF154-01	↔	1
44	Tapping Screw	QW125-02	↔	1	87	Rod Clamp Nut	CF161-01	↔	2
45	Click Spring	DF022-01	↔	1	88	Mylar Washer	BAA076-01	↔	1
					89	Bait Click Lever Bushing	CM088-01	↔	1

Mylar WasheBAA076-01
Bait Click LeiCM088-01

Rev.2 7/26/2012
Rev.3 9/5/2012
Rev.B 2/1/2013

Rev.C 10/18/2016 ECN00135